

BASIC M18

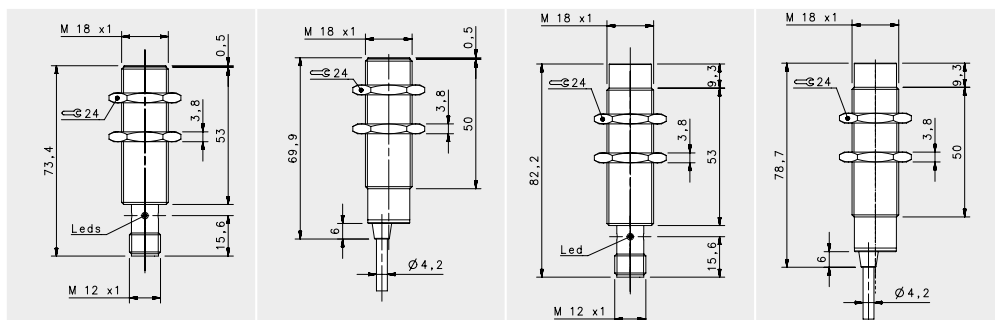

STANDARD X2

| | | | | FLUSH | | NON FLUSH | |
|----------------------------|---|----------|-----------|--|--------------------------|--|--------------------------|
| | | | | M12 conn | cable | M12 conn | cable |
| NOMINAL SWITCHING DISTANCE | | | | 8 mm | | 14 mm | |
| 10-30 Vdc | PNP/NPN NO-NC | 4 wires | order No. | IS-18-E0-S2 95B067310 | IS-18-E0-03 95B067270 | IS-18-F0-S2 95B067330 | IS-18-F0-03 95B067290 |
| 10-30 Vdc | PNP NO | 3 wires | order No. | IS-18-E1-S2 95B067050 | IS-18-E1-03 95B067810 | IS-18-F1-S2 95B067040 | IS-18-F1-03 95B067880 |
| 10-30 Vdc | PNP NC | 3 wires | order No. | IS-18-E2-S2 95B067780 | IS-18-E2-03 95B067820 | IS-18-F2-S2 95B067850 | IS-18-F2-03 95B067890 |
| 10-30 Vdc | NPN NO | 3 wires | order No. | IS-18-E3-S2 95B067790 | IS-18-E3-03 95B067830 | IS-18-F3-S2 95B067860 | IS-18-F3-03 95B067900 |
| 10-30 Vdc | NPN NC | 3 wires | order No. | IS-18-E4-S2 95B067800 | IS-18-E4-03 95B067840 | IS-18-F4-S2 95B067870 | IS-18-F4-03 95B067910 |
| 10-30 Vdc | PNP NO-NC | 4 wires | order No. | --- | --- | --- | --- |
| 10-30 Vdc | NPN NO-NC | 4 wires | order No. | --- | --- | --- | --- |
| 10-30 Vdc | NO-NC | 2 wires | order No. | IS-18-E9-S2 95B067320 | IS-18-E9-03 95B067280 | IS-18-F9-S2 95B067340 | IS-18-F9-03 95B067300 |
| 20-250 Vac/Vdc | NO | 2 wires | order No. | --- | --- | --- | --- |
| 20-250 Vac/Vdc | NC | 2 wires | order No. | --- | --- | --- | --- |
| 20-250 Vac | NO | 2/3wires | order No. | --- | --- | --- | --- |
| 10-30 Vdc | Analog 0-20 mA | 3 wires | order No. | --- | --- | --- | --- |
| NAMUR amplifier | NAMUR | 2 wires | order No. | --- | --- | --- | --- |
| Nominal Voltage | 10-30 Vdc (-15/10%) | | | 10-30 Vdc (-15/10%) | | 10-30 Vdc (-15/10%) | |
| Residual Ripple | < 10% | | | < 10% | | < 10% | |
| Hysteresis | < 10% | | | < 10% | | < 10% | |
| Max. Output Current | 200 mA | | | 200 mA | | 200 mA | |
| Min. Output Current | --- | | | --- | | --- | |
| Residual Current | < 10 mA | | | < 10 mA | | < 10 mA | |
| Voltage Drop | < 1,2 V (I=100mA) | | | < 1,2 V (I=100mA) | | < 1,2 V (I=100mA) | |
| Operation Led | Yellow | | | Yellow | | Yellow | |
| Switching Frequency | 400 Hz | | | 400 Hz | | 100 Hz | |
| Start Up Delay | < 50 ms | | | < 50 ms | | < 50 ms | |
| Repeatability | < 3% | | | < 3% | | < 3% | |
| Short Circuit Protection | Present (self-resetting) | | | Present (self-resetting) | | Present (self-resetting) | |
| Electric Protection | Against polarity reversal inductive loads | | | Against polarity reversal inductive loads | | Against polarity reversal inductive loads | |
| Temperature Limit | (-25 ... +70 °C) | | | (-25 ... +70 °C) | | (-25 ... +70 °C) | |
| Protection Degree | IP67 | | | IP67 | | IP67 | |
| Cable Length | --- | | | --- | | --- | |
| Cable Section | --- | | | 2 x 0,34 mm ² 3 x 0,14 mm ² 4 x 0,25 mm ² | | 2 x 0,34 mm ² 3 x 0,14 mm ² 4 x 0,25 mm ² | |
| Housing Material | Nickel-plated brass | | | Nickel-plated brass | | Nickel-plated brass | |
| Active face | LCP | | | LCP | | LCP | |
| Tightening torque | 30Nm | | | 30Nm | | 30Nm | |
| Weight - Cable Output | --- | | | --- | | 145g | |
| Weight - Connector Output | 95g | | | 95g | | --- | |