



SAFETY SWITCHES

KATKO oy
 Karhunkierros 6
 P.O. Box 12, Vantaa, Finland
 +358 9 849600
 info@katko.com
 www.katko.com

KATKO OY (DMCC BRANCH)
 Reef Tower, Jumeirah Lakes Tower
 P.O. Box 5003335, Dubai, UAE
 +971 4 4487405
 info@katko.com
 www.katko.com

SAFETY SWITCHES
10 - 630 A
POLYCARBONATE



AC-22 / 415V	AC-23 / 415V	Type	Enclosure	EAN G/B		IP
				6419410...		
3 poles						
10 A	10 A / 5.5 kW	KEM 310U	U2	...327654	...327722	66
16 A	16 A / 7.5 kW	KEM 316U	U2	...327661	...327739	66
25 A	25 A / 11 kW	KEM 325U	U2	...327685	...327753	66
40 A	40 A / 22 kW	KEM 340U	U2	...327708	...327777	66
63 A	40 A / 22 kW	KEM 363U	U3	...399637	...399644	66
80 A	63 A / 30 kW	KEM 380U	U3	...399651	...399668	66
125 A	100 A / 55 kW	KEM 3125U	U4	...481721	...481738	66
160 A	135 A / 75 kW	KEM 3160	MF11	...323403	...319505	65
200 A	200 A / 110 kW	KEM 3200	MF03	...323809	...319826	65
200 A	200 A / 110 kW	KEM 3200C	MF11	...323816	...323823	65
250 A	250 A / 132 kW	KEM 3250	MF03	...324202	...319888	65
250 A	250 A / 132 kW	KEM 3250C	MF11	...324219	...324226	65
315 A	315 A / 160 kW	KEM 3315	MF03	...324608	...319949	65
400 A	400 A / 200 kW	KEM 3400	MF03	...325001	...320006	65
630 A	630 A / 355 kW	KEM 3630	MF04	...325407	...320068	65
4 poles						
10 A	10 A / 5.5 kW	KEM 410U	U2	...321072	...301487	66
16 A	16 A / 7.5 kW	KEM 416U	U2	...327678	...327746	66
25 A	25 A / 11 kW	KEM 425U	U2	...327692	...327760	66
40 A	40 A / 22 kW	KEM 440U	U2	...327715	...327784	66
63 A	40 A / 22 kW	KEM 463U	U3	...399675	...399682	66
80 A	63 A / 30 kW	KEM 480U	U3	...399699	...399705	66
125 A	100 A / 55 kW	KEM 4125U	U4	...323120	...323144	66
160 A	135 A / 75 kW	KEM 4160	MF11	...323502	...319604	65
200 A	200 A / 110 kW	KEM 4200	MF03	...323908	...323922	65
200 A	200 A / 110 kW	KEM 4200C	MF11	...323915	...323939	65
250 A	250 A / 132 kW	KEM 4250	MF03	...324325	...324349	65
250 A	250 A / 132 kW	KEM 4250C	MF11	...324332	...324356	65
315 A	315 A / 160 kW	KEM 4315	MF03	...324707	...324721	65
400 A	400 A / 200 kW	KEM 4400	MF03	...325100	...325124	65
630 A	630 A / 355 kW	KEM 4630	MF04	...327616	...327623	65
6 poles						
16 A	16 A / 7.5 kW	KEM 616U	U3	...399712	...399729	66
25 A	25 A / 11 kW	KEM 625U	U3	...399736	...399743	66
40 A	40 A / 22 kW	KEM 640U	U3	...399750	...399767	66
63 A	40 A / 22 kW	KEM 663U	U3	...399774	...399781	66
80 A	63 A / 30 kW	KEM 680U	U3	...399798	...399804	66
125 A	100 A / 55 kW	KEM 6125	MF11	...323205	...319307	65
160 A	135 A / 75 kW	KEM 6160	MF11	...323601	...319703	65

- Padlockable
- Wide operation temperature range
- Good UV protection
- Excellent insulating properties
- Also available as EMC -version
- Available as yellow / red, add Y/R to the end of the type name,
- for example: **KEM 440U Y/R**

ACCESSORIES
AUXILIARY CONTACTS

Type	For	Description	EAN
			6419410...
KU1.V	KU Switch	1NO+1NC	...300008
KU2.V	KU Switch	2NO+2NC	...300107

- For KEM, KEA and KER safety switches

SAFETY SWITCHES
16 - 250 A
ALUMINIUM



AC-22 / 415V	AC-23 / 415V	Type	Enclosure	EAN G/B		EAN Y/R		IP
				6419410...				
3 poles								
16 A	16 A / 7.5 kW	KEA 316U	A2	...330036	...330043	66		
25 A	25 A / 11 kW	KEA 325U	A2	...330234	...330241	66		
40 A	40 A / 22 kW	KEA 340U	A2	...330432	...330449	66		
63 A	40 A / 22 kW	KEA 363U	A3	...329566	...329740	66		
80 A	63 A / 30 kW	KEA 380U	A3	...329603	...329788	66		
125 A	100 A / 55 kW	KEA 3125U	A3	...329641	...329825	66		
160 A	135 A / 75 kW	KEA 3160U	A3	...329665	...329849	66		
200 A	200 A / 110 kW	KEA 3200	A5	...332641	...332658	65		
200 A	200 A / 110 kW	KEA 3200C	A4	...332900	...332917	65		
250 A	250 A / 132 kW	KEA 3250	A5	...332665	...332672	65		
250 A	250 A / 132 kW	KEA 3250C	A4	...332924	...332931	65		
4 poles								
16 A	16 A / 7.5 kW	KEA 416U	A2	...330050	...330067	66		
25 A	25 A / 11 kW	KEA 425U	A2	...330258	...330265	66		
40 A	40 A / 22 kW	KEA 440U	A2	...330456	...330463	66		
63 A	40 A / 22 kW	KEA 463U	A3	...329573	...329757	66		
80 A	63 A / 30 kW	KEA 480U	A3	...329610	...329795	66		
125 A	100 A / 55 kW	KEA 4125U	A3	...329658	...329832	66		
160 A	135 A / 75 kW	KEA 4160U	A3	...329672	...329856	66		
200 A	200 A / 110 kW	KEA 4200	A5	...358061	...358078	65		
200 A	200 A / 110 kW	KEA 4200C	A4	...332948	...332955	65		
250 A	250 A / 132 kW	KEA 4250	A5	...358085	...358092	65		
250 A	250 A / 132 kW	KEA 4250C	A4	...332962	...332979	65		
6 poles								
16 A	16 A / 7.5 kW	KEA 616U	A3	...329504	...329689	66		
25 A	25 A / 11 kW	KEA 625U	A3	...329528	...329702	66		
40 A	40 A / 22 kW	KEA 640U	A3	...329542	...329726	66		
63 A	40 A / 22 kW	KEA 663U	A3	...329580	...329764	66		
80 A	63 A / 30 kW	KEA 680U	A3	...329627	...329801	66		
125 A	100 A / 55 kW	KEA 6125	A4	...332207	...332207	65		
160 A	135 A / 75 kW	KEA 6160	A4	...332603	...336410	65		

- Degree of mechanical impact:
- IK08: A2, A3
- IK10: A4, A5
- Door interlock with defeat mechanism
- Padlockable
- Also available as EMC -version
- Available as yellow / red, add Y/R to the end of the type name

ACCESSORIES
PROTECTIVE VISORS

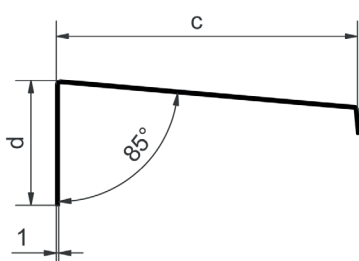
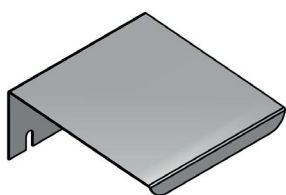

Type	For	Dimensions mm						EAN	
		a	b	c	d	e	f	6419410...	
KSL 10	U2	120	84	125	52	10	6	...353257	
KSL 20	U3	156	131	140	62	10	6	...353264	
KSL 30	TR02 / H02	350	260	200	83	40	9	...353271	
KSL 50	TR03 / H03	410	340	300	83	26	9	...353288	
KSL 70	TR04 / H04	630	542	340	80	30	9	...353295	
KSL 100	TR07 / H07	830	742	390	80	30	9	...353301	

- Material: AlZn
- Extra protection for enclosed switches
- With modifications:
- KSL 30 for MF01
- KSL 50 for MF03
- KSL 70 for MF04

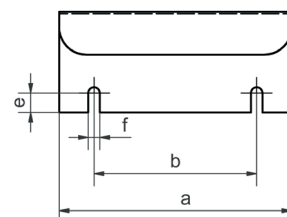

SAFETY SWITCHES
16 - 200 A
 FIRERATED ALUMINIUM



AC-22 / 415 V	AC-23 / 415 V	Type	Enclosure		EAN FR3	EAN FR	IP
					6419410...		
3 poles							
16 A	16 A / 7.5 kW	KEA 316U FR3	A2		...333396	...305294	66
25 A	25 A / 11 kW	KEA 325U FR3	A2		...333426	...305300	66
40 A	40 A / 22 kW	KEA 340U FR3	A2		...333457	...305317	66
63 A	40 A / 22 kW	KEA 363U FR3	A3		...333488	...305324	66
80 A	63 A / 30 kW	KEA 380U FR3	A3		...333518	...305331	66
125 A	100 A / 55 kW	KEA 3125 FR3	A4		...333549	...305492	65
160 A	135 A / 75 kW	KEA 3160 FR3	A4		...333556	...305508	65
200 A	200 A / 110 kW	KEA 3200C FR3	A4		...333563	...305515	65
4 poles							
16 A	16 A / 7.5 kW	KEA 416U FR3	A2		...333402	...305348	66
25 A	25 A / 11 kW	KEA 425U FR3	A2		...333433	...305355	66
40 A	40 A / 22 kW	KEA 440U FR3	A2		...333464	...305362	66
63 A	40 A / 22 kW	KEA 463U FR3	A3		...333495	...305379	66
80 A	63 A / 30 kW	KEA 480U FR3	A3		...333525	...305386	66
125 A	100 A / 55 kW	KEA 4125 FR3	A4		...333570	...305522	65
160 A	135 A / 75 kW	KEA 4160 FR3	A4		...333587	...305539	65
200 A	200 A / 110 kW	KEA 4200C FR3	A4		...333594	...305546	65
6 poles							
16 A	16 A / 7.5 kW	KEA 616U FR3	A3		...333419	...305393	66
25 A	25 A / 11 kW	KEA 625U FR3	A3		...333440	...305409	66
40 A	40 A / 22 kW	KEA 640U FR3	A3		...333471	...305416	66
63 A	40 A / 22 kW	KEA 663U FR3	A3		...333501	...305423	66
80 A	63 A / 30 kW	KEA 680U FR3	A3		...333532	...305430	66
125 A	100 A / 55 kW	KEA 6125 FR3	A5		...333600	...305553	65
160 A	135 A / 75 kW	KEA 6160 FR3	A5		...333617	...305560	65
200 A	200 A / 110 kW	KEA 6200C FR3	A5		...333624	...305577	65

- **F200 FR = 200°C for 3 hours, for type name, replace FR3 with FR, for example: KEA 4200C FR**
- **F300 FR3 = 300°C for 2 hours**
- Same properties as in aluminium enclosure

SAFETY SWITCHES
16 - 160 A
 STAINLESS STEEL
 (ST. STEEL HANDLE)



RS

R

AC-22 / 415V	AC-23 / 415V	Type	Enclosure		EAN R	EAN RS
			R	RS	6419410...	
3 poles						
16 A	16 A / 7.5 kW	KER 316R	H23T	H24T	...306550	...306611
25 A	25 A / 11 kW	KER 325R	H23T	H24T	...306567	...306628
40 A	40 A / 22 kW	KER 340R	H23T	H24T	...306574	...306635
63 A	40 A / 22 kW	KER 363R	H32T	H34T	...306703	...307052
80 A	63 A / 30 kW	KER 380R	H32T	H34T	...306710	...307069
125 A	100 A / 55 kW	KER 3125R	H02T	H02TR	...357828	...357835
160 A	135 A / 75 kW	KER 3160R	H02T	H02TR	...357842	...357859
4 poles						
16 A	16 A / 7.5 kW	KER 416R	H23T	H24T	...306581	...306642
25 A	25 A / 11 kW	KER 425R	H23T	H24T	...306598	...306659
40 A	40 A / 22 kW	KER 440R	H23T	H24T	...306604	...306666
63 A	40 A / 22 kW	KER 463R	H32T	H34T	...306727	...307076
80 A	63 A / 30 kW	KER 480R	H32T	H34T	...306734	...307083
125 A	100 A / 55 kW	KER 4125R	H02T	H02TR	...305720	...305737
160 A	135 A / 75 kW	KER 4160R	H02T	H02TR	...305744	...305751

- Excellent for food & beverage and mining industries
- RS model: rainhood protection with angled top
- RS, add S to the end of the type name, for example: **KER 363RS**
- Acid proof, AISI 316
- Hygienic design
- IP 66

SAFETY SWITCHES 16 - 1600 A

STAINLESS STEEL
(POLYCARBONATE
HANDLE)



AC-22 / 415V	AC-23 / 415V	Type	Enclosure	EAN G/B	EAN Y/R	IP
				6419410...		
3 poles						
16 A	16 A / 7.5 kW	KER 316	H23	...343005	...343050	66
25 A	25 A / 11 kW	KER 325	H23	...343203	...343258	66
40 A	40 A / 22 kW	KER 340	H23	...343401	...343456	66
63 A	40 A / 22 kW	KER 363	H32	...343562	...343579	66
80 A	63 A / 30 kW	KER 380	H32	...343609	...343616	66
125 A	100 A / 55 kW	KER 3125	H02	...343647	...343654	66
160 A	135 A / 75 kW	KER 3160	H02	...343685	...343692	66
200 A	200 A / 110 kW	KER 3200	H03	...343722	...343739	65
200 A	200 A / 110 kW	KER 3200C	H02	...347805	...347812	66
250 A	250 A / 132 kW	KER 3250	H03	...343784	...343791	65
250 A	250 A / 132 kW	KER 3250C	H02	...347829	...347836	66
315 A	315 A / 160 kW	KER 3315	H03	...343845	...343852	65
400 A	400 A / 200 kW	KER 3400	H03	...343906	...343913	65
630A	630 A / 355 kW	KER 3630	H04	...343968	...343975	65
800 A	800 A / 400 kW	KER 3800T	H08	...305645	...305652	65
1000 A	1000 A / 560 kW	KER 31000T	H07	...305669	...305676	65
1250 A	1250 A / 710 kW	KER 31250T	H07	...305683	...305690	65
1600 A	1600 A / 900 kW	KER 31600T	H07	...305706	...305713	65
4 poles						
16 A	16 A / 7.5 kW	KER 416	H23	...343104	...343159	66
25 A	25 A / 11 kW	KER 425	H23	...343302	...343357	66
40 A	40 A / 22 kW	KER 440	H23	...343500	...343555	66
63 A	40 A / 22 kW	KER 463	H32	...343586	...343593	66
80 A	63 A / 30 kW	KER 480	H32	...343623	...343630	66
125 A	100 A / 55 kW	KER 4125	H02	...343661	...343678	66
160 A	135 A / 75 kW	KER 4160	H02	...343708	...343715	66
200 A	200 A / 110 kW	KER 4200	H03	...343746	...343753	65
200 A	200 A / 110 kW	KER 4200C	H02	...347843	...347850	66
250 A	250 A / 132 kW	KER 4250	H03	...343807	...343814	65
250 A	250 A / 132 kW	KER 4250C	H02	...347867	...347874	66
315 A	315 A / 160 kW	KER 4315	H03	...343869	...343876	65
400 A	400 A / 200 kW	KER 4400	H03	...343920	...343937	65
630 A	630 A / 355 kW	KER 4630	H04	...344002	...344019	65
800 A	800 A / 400 kW	KER 4800T	H08	...363843	...363881	65
1000 A	1000 A / 560 kW	KER 41000T	H07	...363850	...363898	65
1250 A	1250 A / 710 kW	KER 41250T	H07	...363867	...363904	65
1600 A	1600 A / 900 kW	KER 41600T	H07	...363874	...363911	65
6 poles						
16 A	16 A / 7.5 kW	KER 616	H32	...342879	...342237	66
25 A	25 A / 11 kW	KER 625	H32	...342893	...342251	66
40 A	40 A / 22 kW	KER 640	H32	...342916	...342275	66
63 A	40 A / 22 kW	KER 663	H32	...342930	...342299	66
80 A	63 A / 30 kW	KER 680	H32	...342954	...342312	66
125 A	100 A / 55 kW	KER 6125	H02	...342978	...342336	66
160 A	135 A / 75 kW	KER 6160	H02	...342992	...342367	66
200 A	200 A / 110 kW	KER 6200	H04	...343760	...343777	65
250 A	250 A / 132 kW	KER 6250	H04	...343821	...343838	65
315 A	315 A / 160 kW	KER 6315	H06	...343883	...343890	65
400 A	400 A / 200 kW	KER 6400	H06	...343944	...343951	65

- Padlockable
- Available as EMC and ATEX -version
- H23, H32, H02 = AISI 316 (acid proof)
- H03, H04, H06, H07, H08 = AISI 304 (stainless steel) [AISI 316 on request]
- Excellent insulating properties
- Available with yellow / red handle, add Y/R to the end of the type name

SAFETY SWITCHES
16 - 1600 A
SHEET STEEL

AC-22 / 415V	AC-23 / 415V	Type	Enclosure	EAN G/B		IP
				6419410...		
3 poles						
16 A	16 A / 7.5 kW	KET 316	TR007	...339800	...341513	65
25 A	25 A / 11 kW	KET 325	TR007	...339848	...341551	65
40 A	40 A / 22 kW	KET 340	TR007	...339886	...341599	65
63 A	40 A / 22 kW	KET 363	TR007	...339923	...341636	65
80 A	63 A / 30 kW	KET 380	TR007	...339961	...341735	65
125 A	100 A / 55 kW	KET 3125	TR01	...339251	...339268	65
160 A	135 A / 75 kW	KET 3160	TR02	...339299	...339305	65
200 A	200 A / 110 kW	KET 3200	TR03	...336700	...336724	65
200 A	200 A / 110 kW	KET 3200C	TR02	...336731	...336748	65
250 A	250 A / 132 kW	KET 3250	TR03	...337103	...337127	65
250 A	250 A / 132 kW	KET 3250C	TR02	...337134	...337141	65
315 A	315 A / 160 kW	KET 3315	TR03	...337509	...337523	65
400 A	400 A / 200 kW	KET 3400	TR03	...337905	...337929	65
630 A	630 A / 355 kW	KET 3630	TR04	...338308	...338322	65
800 A	800 A / 400 kW	KET 3800T	TR05	...338360	...338377	65
1000 A	1000 A / 560 kW	KET 31000T	TR05	...338384	...338391	65
1250 A	1250 A / 710 kW	KET 31250T	TR05	...338407	...338414	65
1600 A	1600 A / 900 kW	KET 31600T	TR05	...338421	...338438	65
4 poles						
16 A	16 A / 7.5 kW	KET 416	TR007	...339817	...341520	65
25 A	25 A / 11 kW	KET 425	TR007	...339855	...341568	65
40 A	40 A / 22 kW	KET 440	TR007	...339893	...341605	65
63 A	40 A / 22 kW	KET 463	TR007	...339930	...341643	65
80 A	63 A / 30 kW	KET 480	TR007	...339978	...341742	65
125 A	100 A / 55 kW	KET 4125	TR01	...339275	...339282	65
160 A	135 A / 75 kW	KET 4160	TR02	...339312	...339329	65
200 A	200 A / 110 kW	KET 4200	TR03	...341315	...341339	65
200 A	200 A / 110 kW	KET 4200C	TR02	...341346	...341353	65
250 A	250 A / 132 kW	KET 4250	TR03	...341711	...341698	65
250 A	250 A / 132 kW	KET 4250C	TR02	...341773	...341780	65
315 A	315 A / 160 kW	KET 4315	TR03	...337547	...337554	65
400 A	400 A / 200 kW	KET 4400	TR03	...337967	...337974	65
630 A	630 A / 355 kW	KET 4630	TR04	...338346	...338353	65
800 A	800 A / 400 kW	KET 4800T	TR05	...342015	...363805	65
1000 A	1000 A / 560 kW	KET 41000T	TR05	...342022	...363812	65
1250 A	1250 A / 710 kW	KET 41250T	TR05	...342039	...363829	65
1600 A	1600 A / 900 kW	KET 41600T	TR05	...342046	...363836	65
6 poles						
16 A	16 A / 7.5 kW	KET 616	TR007	...339824	...341537	65
25 A	25 A / 11 kW	KET 625	TR007	...339862	...341575	65
40 A	40 A / 22 kW	KET 640	TR007	...339909	...341612	65
63 A	40 A / 22 kW	KET 663	TR007	...339947	...341650	65
80 A	63 A / 30 kW	KET 680	TR007	...339985	...341759	65
125 A	100 A / 55 kW	KET 6125	TR02	...338902	...341254	65
160 A	135 A / 75 kW	KET 6160	TR02	...338926	...341278	65
200 A	200 A / 110 kW	KET 6200	TR04	...341438	...341445	65
250 A	250 A / 132 kW	KET 6250	TR04	...341834	...341841	65
315 A	315 A / 160 kW	KET 6315	TR06	...337561	...337707	65
400 A	400 A / 200 kW	KET 6400	TR06	...338100	...338117	65

- Padlockable
- Available as EMC -version
- Good corrosion resistance
- Excellent insulating properties
- Available with yellow/red handle, add Y/R to the end of the type name